

Larissa

Complete Product
Mechanism + Cover Plate +
Frame + Thin Frame



It Matches
You Way
Of Line





EXPRESS YOUR STYLE - ALWAYS TRENDY

With a rounded shape but a classic look, LARISSA is the line of Mono domestic range dedicated to all who wish to furnish their home in the name of simplicity. With this collection, in most favourite colours, you can update your home decoration whenever you feel like a new look.

COLOURS



White



Ivory



Cream



One Way Switch	
10AX, 250 V	
Screwless Code	103-XXXX 35-100
Screw Type Code	103-XXXX 25-100
Box Quantity	10
Package Quantity	100
Gross Weight	10,20
Volume m ³	0,043



One Way Switch Illuminated	
10AX, 250 V	
Screwless Code	103-XXXX 35-101
Screw Type Code	103-XXXX 25-101
Box Quantity	10
Package Quantity	50
Gross Weight	5,15
Volume m ³	0,022



Double One Way Switch	
10AX, 250 V	
Screwless Code	103-XXXX 35-102
Screw Type Code	103-XXXX 25-102
Box Quantity	10
Package Quantity	100
Gross Weight	10,25
Volume m ³	0,043



Double One Way Switch Illuminated	
10AX, 250 V	
Screwless Code	103-XXXX 35-103
Screw Type Code	103-XXXX 25-103
Box Quantity	10
Package Quantity	50
Gross Weight	5,30
Volume m ³	0,022



Two Way Switch	
10AX, 250 V	
Screwless Code	103-XXXX 35-109
Screw Type Code	103-XXXX 25-109
Box Quantity	10
Package Quantity	100
Gross Weight	10,30
Volume m ³	0,043



Two Way Switch Illuminated	
10AX, 250 V	
Screwless Code	103-XXXX 35-110
Screw Type Code	103-XXXX 25-110
Box Quantity	10
Package Quantity	50
Gross Weight	5,21
Volume m ³	0,022



Double Two Way Switch	
10AX, 250 V	
Screwless Code	103-XXXX 33-111
Screw Type Code	103-XXXX 23-111
Box Quantity	10
Package Quantity	50
Gross Weight	5,62
Volume m ³	0,022



Two Way Switch - Intermediate	
10AX, 250 V	
Screwless Code	103-XXXX 35-112
Screw Type Code	103-XXXX 25-112
Box Quantity	10
Package Quantity	50
Gross Weight	5,49
Volume m ³	0,022



Control Switch - Light	
10AX, 250 V	
Screwless Code	103-XXXX 35-105
Screw Type Code	103-XXXX 25-105
Box Quantity	10
Package Quantity	100
Gross Weight	10,15
Volume m ³	0,043



Control Switch - Light Illuminated	
10AX, 250 V	
Screwless Code	103-XXXX 35-106
Screw Type Code	103-XXXX 25-106
Box Quantity	10
Package Quantity	50
Gross Weight	5,08
Volume m ³	0,022



Control Switch - Bell	
10AX, 250 V	
Screwless Code	103-XXXX 35-107
Screw Type Code	103-XXXX 25-107
Box Quantity	10
Package Quantity	100
Gross Weight	10,30
Volume m ³	0,043



Control Switch - Bell Illuminated	
10AX, 250 V	
Screwless Code	103-XXXX 35-155
Screw Type Code	103-XXXX 25-155
Box Quantity	10
Package Quantity	50
Gross Weight	5,05
Volume m ³	0,022

Please specify your choice for product and frame colours by applying below codes 'XXXX' marked space.

XXXX:  1919 WHITE  0101 IVORY  1717 CREAM



Control Switch - Bell With Name Plate	
10AX, 250 V	
Screwless Code	103-XXXX 35-129
Screw Type Code	103-XXXX 25-129
Box Quantity	10
Package Quantity	50
Gross Weight	5,16
Volume m ³	0,022



Control Switch - Door	
10AX, 250 V	
Screwless Code	103-XXXX 35-104
Screw Type Code	103-XXXX 25-104
Box Quantity	10
Package Quantity	50
Gross Weight	5,45
Volume m ³	0,022



Roller Blind Two Way Switch	
10AX, 250 V	
Screw Type Code	103-XXXX 25-159
Box Quantity	10
Package Quantity	50
Gross Weight	5,00
Volume m ³	0,022



Roller Blinds Double One Way Switch	
10AX, 250 V	
Screwless Code	103-XXXX 35-113
Screw Type Code	103-XXXX 25-113
Box Quantity	10
Package Quantity	50
Gross Weight	5,50
Volume m ³	0,022



Air Conditioning Switch	
25A, 250 V	
Screw Type Code	103-XXXX 06-115
Box Quantity	10
Package Quantity	50
Gross Weight	5,09
Volume m ³	0,022



Heater - Boiler Switch	
25A, 250 V	
Screw Type Code	103-XXXX 06-154
Box Quantity	10
Package Quantity	50
Gross Weight	5,35
Volume m ³	0,022



Triple One Way Switch (3 Gang 1 Way)	
10AX, 250 V	
Screwless Code	103-XXXX 32-114
Screw Type Code	103-XXXX 22-114
Box Quantity	10
Package Quantity	50
Gross Weight	5,48
Volume m ³	0,022



Triple Two Way Switch (3 Gang 2 Way)	
10AX, 250 V	
Screw Type Code	103-XXXX 02-108
Box Quantity	10
Package Quantity	50
Gross Weight	5,72
Volume m ³	0,022



Cooling Switch	
16A, 250 V	
Screw Type Code	103-XXXX 06-141
Box Quantity	10
Package Quantity	50
Gross Weight	5,35
Volume m ³	0,022



Audio Switch	
Screw Type Code	103-XXXX 06-123
Box Quantity	6
Package Quantity	30
Gross Weight	3,50
Volume m ³	0,022



Dimmer 800W / Dimmer Filtered 500W	
Screw Type Code	103-XXXX 05-134
	103-XXXX 05-135
Box Quantity	6
Package Quantity	30
Gross Weight	3,80 / 4,20
Volume m ³	0,022



Two Way Dimmer 300W RC Dimmer 300W	
Screw Type Code	103-XXXX 05-147
	103-XXXX 05-179
Box Quantity	6
Package Quantity	30
Gross Weight	3,50 / 3,55
Volume m ³	0,022

Example: 103-191925-100 → Frame "White" (code 19) With Thin Frame "White" (code 19)
Or: 103-190000-160 → Frame "White" (code 19) Without Thin Frame (code 00)



Hotel Warning System Interior Unit	
10AX, 250 V	
Screw Type Code	103-XXXX 05-186
Box Quantity	1
Package Quantity	-
Gross Weight	-
Volume m ³	-



Hotel Warning System Exterior Unit	
10AX, 250 V	
Screw Type Code	103-XXXX 05-187
Box Quantity	1
Package Quantity	-
Gross Weight	-
Volume m ³	-



Automation Switch	
Automation Switch Single Phase	
Automation Switch Double Phase	
10AX, 250 V	
Screw Type Code	103-XXXX 05-172
	103-XXXX 05-173
	103-XXXX 05-174
Box Quantity	10
Package Quantity	100
Gross Weight	9,95 / 9,20 / 9,20
Volume m ³	0,043



Energy Saver Optic	
Energy Saver RFID	
Energy Saver Mechanical (220V)	
Screw Type Code	103-XXXX 05-136
	103-XXXX 25-136
	103-XXXX 05-152
Box Quantity	1
Package Quantity	50
Gross Weight	5,06
Volume m ³	0,022



Socket Outlet	
16A, 250 V	
Screwless Code	103-XXXX 32-116
Screw Type Code	103-XXXX 22-116
Box Quantity	10
Package Quantity	100
Gross Weight	9,19
Volume m ³	0,043

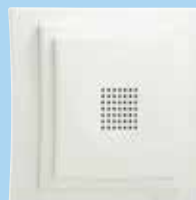

Buzzer Bell	
Screw Type Code	103-XXXX 05-133
Box Quantity	6
Package Quantity	30
Gross Weight	2,95
Volume m ³	0,022



Socket Outlet Earthed	
16A, 250 V	
Screwless Code	103-XXXX 31-117
Screw Type Code	103-XXXX 21-117
Box Quantity	10
Package Quantity	100
Gross Weight	10,03
Volume m ³	0,043



Childproof Socket Outlet Earthed	
16A, 250 V	
Screwless Code	103-XXXX 31-119
Screw Type Code	103-XXXX 21-119
Box Quantity	10
Package Quantity	100
Gross Weight	10,23
Volume m ³	0,043



Socket Outlet Earthed With Protection Cover	
16A, 250 V	
Screwless Code	103-XXXX 31-118
Screw Type Code	103-XXXX 21-118
Box Quantity	10
Package Quantity	100
Gross Weight	10,40
Volume m ³	0,043



Childproof Socket Outlet Earthed With Protection Cover	
16A, 250 V	
Screwless Code	103-XXXX 31-158
Screw Type Code	103-XXXX 21-158
Box Quantity	10
Package Quantity	50
Gross Weight	5,50
Volume m ³	0,022



UPS Socket Outlet	
16A, 250 V	
Screwless Code	103-XXXX 33-122
Screw Type Code	103-XXXX 23-122
Box Quantity	10
Package Quantity	100
Gross Weight	10,20
Volume m ³	0,043



UPS Childproof Socket Outlet	
16A, 250 V	
Screwless Code	103-XXXX 33-129
Screw Type Code	103-XXXX 23-129
Box Quantity	10
Package Quantity	100
Gross Weight	10,20
Volume m ³	0,043

Please specify your choice for product and frame colours by applying below codes 'XXXX' marked space.

XXXX: ○ 1919 WHITE ○ 0101 IVORY ○ 1717 CREAM



Double Socket Outlet Earthed	
16A, 250 V	
Screw Type Code	103-XXXX 04-120
Box Quantity	5
Package Quantity	50
Gross Weight	7,30
Volume m ³	0,043



Double Childproof Socket Outlet Earthed	
16A, 250 V	
Screw Type Code	103-XXXX 04-123
Box Quantity	5
Package Quantity	50
Gross Weight	7,30
Volume m ³	0,043



Double Socket Outlet	
16A, 250 V	
Screw Type Code	103-XXXX 05-121
Box Quantity	6
Package Quantity	60
Gross Weight	7,60
Volume m ³	0,043



Cable Outlet Cover (Empty)	
Code	103-XXXX 05-175
Box Quantity	10
Package Quantity	50
Gross Weight	3,92
Volume m ³	0,022



TV Socket Outlet - Through Line (11 dB)	
TV Socket Outlet - End Of Line (0,5 dB)	
TV Satellite Socket Outlet	
Code	103-XXXX 05-137 103-XXXX 05-138 103-XXXX 05-127
Box Quantity	10
Package Quantity	100
Gross Weight	10,05 / 9,97 / 8,35
Volume m ³	0,043



Satellite Socket Outlet (F-Type Female Connector)	
Satellite Socket Outlet - Through Line	
Satellite Socket Outlet - End of Line	
Code	103-XXXX 05-130 103-XXXX 05-148 103-XXXX 05-149
Box Quantity	10
Package Quantity	100 / 50 / 50
Gross Weight	8,46 / 4,91 / 5,06
Volume m ³	0,043 / 0,022 / 0,022



TV Socket Outlet - Through Line	
TV Socket Outlet - End of Line	
Code	103-XXXX 05-170 103-XXXX 05-171
Box Quantity	10
Package Quantity	100
Gross Weight	9,75
Volume m ³	0,043



TV+Satellite Socket Outlet - Through Line (5 dB)	
TV+Satellite Socket Outlet - End Of Line (1 dB)	
Code	103-XXXX 05-139 103-XXXX 05-140
Box Quantity	10
Package Quantity	50
Gross Weight	5,90 / 5,50
Volume m ³	0,022



Audio Socket Outlet	
Code	103-XXXX 05-181
Box Quantity	10
Package Quantity	50
Gross Weight	3,95
Volume m ³	0,022



TV Radio Satellite Socket Outlet - Through Line	
Code	103-XXXX 06-146
Box Quantity	10
Package Quantity	50
Gross Weight	5,05
Volume m ³	0,022



Data Socket Outlet (Empty)	
Code	103-XXXX 05-150
Box Quantity	10
Package Quantity	50
Gross Weight	3,92
Volume m ³	0,022



Double Data Socket Outlet (Empty)	
Code	103-XXXX 05-151
Box Quantity	10
Package Quantity	50
Gross Weight	5,10
Volume m ³	0,022

Example: 103-191925-100 → Frame "White" (code 19) With Thin Frame "White" (code 19)
Or: 103-190000-160 → Frame "White" (code 19) Without Thin Frame (code 00)



Telephone Socket Outlet (Rj11 623K)	
Telephone Socket Outlet (Rj45 Cat 3)	
Code	103-XXXX 05-124
	103-XXXX 25-124
Box Quantity	10
Package Quantity	100
Gross Weight	8,30 / 8,30
Volume m ³	0,043



Double Telephone Socket Outlet (2xRj11 623K)	
Double Telephone Socket Outlet (2xRj45 Cat 3)	
Code	103-XXXX 05-176
	103-XXXX 05-131
Box Quantity	10
Package Quantity	50
Gross Weight	4,26 / 4,73
Volume m ³	0,022



Double Data Socket Outlet (2xRj45 Cat 6)	
Code	103-XXXX 05-126
Box Quantity	10
Package Quantity	50
Gross Weight	4,77
Volume m ³	0,022



Data Socket Outlet (Rj45 Cat 6)	
Data Socket Outlet (Cat 6A)	
Code	103-XXXX 05-125
	103-XXXX 05-190
Box Quantity	10
Package Quantity	50
Gross Weight	4,30 / 4,75
Volume m ³	0,022



Data Socket Outlet (Rj45 Cat 6) With Dustproof Cover	
Code	103-XXXX 05-182
Box Quantity	10
Package Quantity	50
Gross Weight	4,16
Volume m ³	0,022



Data+Telephone Socket Outlet (Rj45 Cat 6+Rj45 Cat 3)	
Code	103-XXXX 05-132
Box Quantity	10
Package Quantity	50
Gross Weight	4,65
Volume m ³	0,022



USB Socket Outlet	
Code	103-XXXX 05-144
Box Quantity	10
Package Quantity	50
Gross Weight	4,30
Volume m ³	0,022



HDMI Socket Outlet	
Code	103-XXXX 05-145
Box Quantity	10
Package Quantity	50
Gross Weight	4,36
Volume m ³	0,022



Music Hi-Fi Socket Outlet - 2 Gang	
Code	103-XXXX 05-142
Box Quantity	10
Package Quantity	50
Gross Weight	3,40
Volume m ³	0,022



USB Charger Socket Outlet (5V - 2,4A)	
Code	103-XXXX 05-177
Box Quantity	6
Package Quantity	30
Gross Weight	3,40
Volume m ³	0,022



VGA Socket Outlet	
Code	103-XXXX 05-180
Box Quantity	10
Package Quantity	50
Gross Weight	4,73
Volume m ³	0,022



Double USB Charger Socket Outlet (5V-2,4A)	
Code	103-XXXX 05-178
Box Quantity	6
Package Quantity	30
Gross Weight	4,95
Volume m ³	0,022

Please specify your choice for product and frame colours by applying below codes 'XXXX' marked space.

XXXX: 1919 WHITE 0101 IVORY 1717 CREAM

PRODUCT CODE	PRODUCT NAME	BOX QUANTITY	PACKAGE QUANTITY	GROSS WEIGHT	VOLUME M ³
FRAMES					
103-XXXX 00-160	Single Frame	26	130	2,45	0,043
103-XXXX 00-161	Double Frame	16	80	2,50	0,022
103-XXXX 00-162	Triple Frame	18	90	3,30	0,022
103-XXXX 00-163	4 Gang Frame	10	40	1,90	0,022
103-XXXX 00-164	5 Gang Frame	10	40	2,45	0,022
103-XXXX 00-165	Frame for Double Socket	16	80	2,81	0,022

Please specify your choice for frame and thin frame colours by applying below codes 'XXXX' marked space.

XXXX: 1919 WHITE 0101 IVORY 1717 CREAM

TECHNICAL DRAWINGS

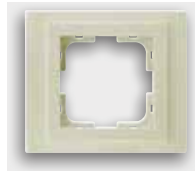
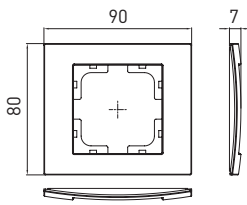

Single Frame

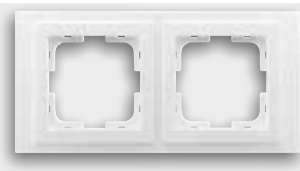

Double Frame

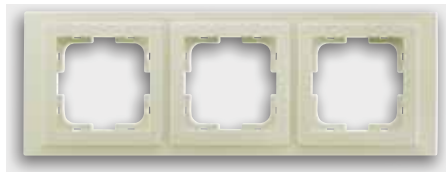
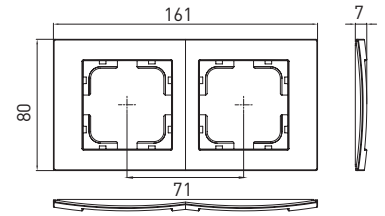

Triple Frame

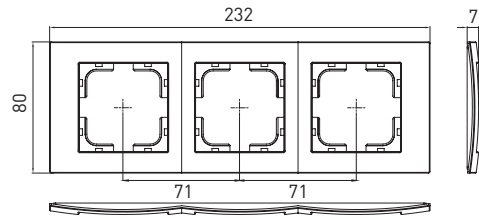

4 Gang Frame

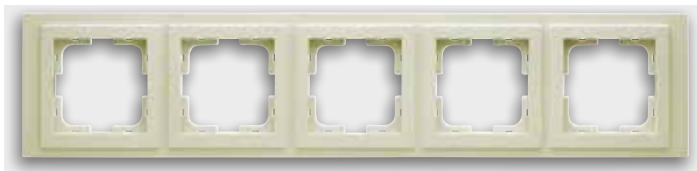
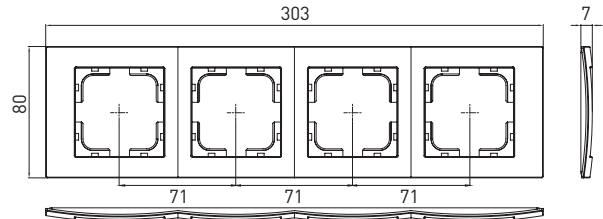

5 Gang Frame

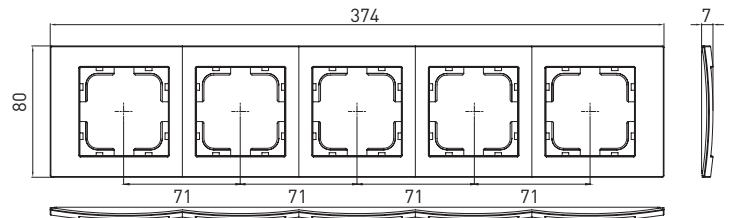

Frame for Double Socket

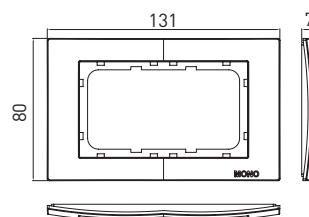

Larissa frames can be used both horizontally and vertically.